

DESIGN CRITERIA

EXISTING 2 BEDROOM RESIDENCE
RAPID SOIL PERMEABILITY
200 SQ.FT./BEDROOM X 2 BEDROOMS X 1.5 = 600 SQ.FT X .66(CLASS I ATU CREDIT
400 SQ.FT. OF SEEPAGE AREA REQUIRED
400 SQ.FT. OF SEEPAGE AREA PROVIDED

GENERAL NOTES:

1. THE SEPTIC SYSTEM INSTALLER SHALL CONTACT THE DESIGNER PRIOR TO ONSET OF CONSTRUCTION TO RESOLVE ANY DISCREPANCIES IF IDENTIFIED.
2. THE AREA IN WHICH THE SEPTIC SYSTEM IS TO BE INSTALLED SHALL BE IDENTIFIED AND SHALL NOT BE CUT, EXCAVATED, FILLED, OR OTHERWISE ALTERED IN ANY WAY EXCEPT AS SPECIFIED IN THE APPROVED PLAN. THE AREA SHALL BE PROTECTED FROM CONSTRUCTION TRAFFIC AND ACTIVITIES THAT MIGHT COMPACT THE SOIL.
3. THE PROPOSED SEEPAGE AREA SHALL HAVE A BARRIER OF SUBSTANTIAL QUALITY TO PREVENT TRAFFICKING OR DISTURBANCES OF THE SEEPAGE AREA PRIOR TO RELEASE OF PERMIT, AND UNTIL THE SEEPAGE SYSTEM IS APPROVED AND BACKFILLED.
4. ANY REMOVAL OF TREES GREATER THAN OR EQUAL TO SIX INCHES IN DIAMETER SHALL BE BY CUTTING NEAR THE SURFACE. STUMPS MAY BE REMOVED BY GRINDING OR CUTTING, BUT SHALL NOT BE UPROOTED.
5. CHISEL PLOW SEPTIC FIELD AREA TO 8" DEEP ALONG CONTOUR WHEN TRENCH DEPTH IS LESS THAN 12" INTO EXISTING GRADE.
6. SEPTIC SYSTEM HAS NOT BEEN SIZED TO ACCOMMODATE HOT TUB USE.
7. SEPTIC FIELD HAS BEEN DETERMINED TO BE OUT OF FLOOD HAZARD.
8. SEPTIC TANK/ATU MUST HAVE ACCESS RISER TO GROUND SURFACE.
9. ATU MUST HAVE AUDIO/VISUAL ALARM MOUNTED OUTSIDE IN ACCORDANCE WITH COUNTY REQUIREMENTS.
10. SEPTIC TANK HAS NOT BEEN SIZED TO ACCOMMODATE GARBAGE DISPOSAL.
11. LIFT STATION IF PROVIDED MUST HAVE ACCESS RISER TO EXTEND 6" ABOVE NORMAL GROUND SURFACE. FORCE MAIN TO PITCH BACK TO TANK; PROVIDE 90° ELBOW AT FIRST TRENCH WITH ANTI-SIPHON HOLE DRILLED IN TOP PIPE FITTINGS SHALL BE LONG SOCKET SOLVENT WELD PRESSURE TYPE; QUICK DISCONNECT TO BE PROVIDED IN DISCHARGE PIPING. CORROSION RESISTANT ROPE OR CABLE TO BE AFFIXED TO PUMP. UTILIZE 1/3 HP EFFLUENT PUMP UNLESS OTHERWISE SPECIFIED; PROVIDE AUDIO VISUAL ALARM; ALARM TO BE SET TO PROVIDE 200 GAL/BEDROOM RESERVE CAPACITY. DOSE AS SPECIFIED ON DESIGN.
12. SEWER LINES 4" PVC SCH 40 OR CAST IRON. HEADER LINES 4" PVC SCH 40. SEEPAGE TILE 4" PERFORATED ASTM 2729 OR GREATER.
13. ALL SEWER LINES/HEADER LINES SHALL BE BEDDED PRIOR TO BACKFILLING.
14. UTILIZE PLASTIC DROP BOXES/DISTRIBUTION BOXES. 3" SOLID HEADER REQUIRED BETWEEN BOXES AND SEEPAGE TILE.
15. ALL CONSTRUCTION/MATERIALS SHALL CONFORM TO THE LOCAL PUBLIC HEALTH ORDINANCE.
16. UNLESS SPECIFIED, NO CESSPOOLS, STORMWATER DRYWELLS, OR LEACH PITS WERE IDENTIFIED WITHIN REQUIRED ORDINANCE SETBACKS.
17. UNLESS SPECIFIED, NO UTILITIES WERE NOTED TO BE IN CONFLICT WITH THE PROPOSED SEPTIC SYSTEM DESIGN. THE SEPTIC SYSTEM INSTALLATION CONTRACTOR IS REQUIRED TO CONTACT J.U.L.I.E. PRIOR TO ONSET OF CONSTRUCTION. UTILITIES SERVICES SHALL NOT CROSS SEPTIC AREA.
18. FILL, IF PROPOSED, AS INDICATED WILL NOT NEGATIVELY AFFECT SURFACE WATER RUNOFF FROM/TO NEIGHBORING PROPERTIES. PROPOSED FILL TO BE 6" TOPSOIL, REMAINDER COARSE GRADED SAND OR POROUS EARTH FILL MEETING ORDINANCE REQUIREMENTS.
19. CLEAR WATER FROM FOOTING DRAINS, AIR CONDITIONERS, DE-HUMIDIFIER, DOWN SPOUTS, PERIPHERAL DRAIN TILE, AND ANY OTHER CLEAR WATER SHALL NOT BE DISCHARGED INTO OR ONTO THE SEPTIC FIELD.
20. PROPOSED CUT WILL NOT ADVERSELY AFFECT DRAINAGE.
21. VARIANCE REQUESTS: ATU/SEEPAGE BED 4' TO PROPERTY LINE, 2.5' TO GAS LINE, SEEPAGE BED 10' TO ADDITION, ATU 3' TO ADDITION

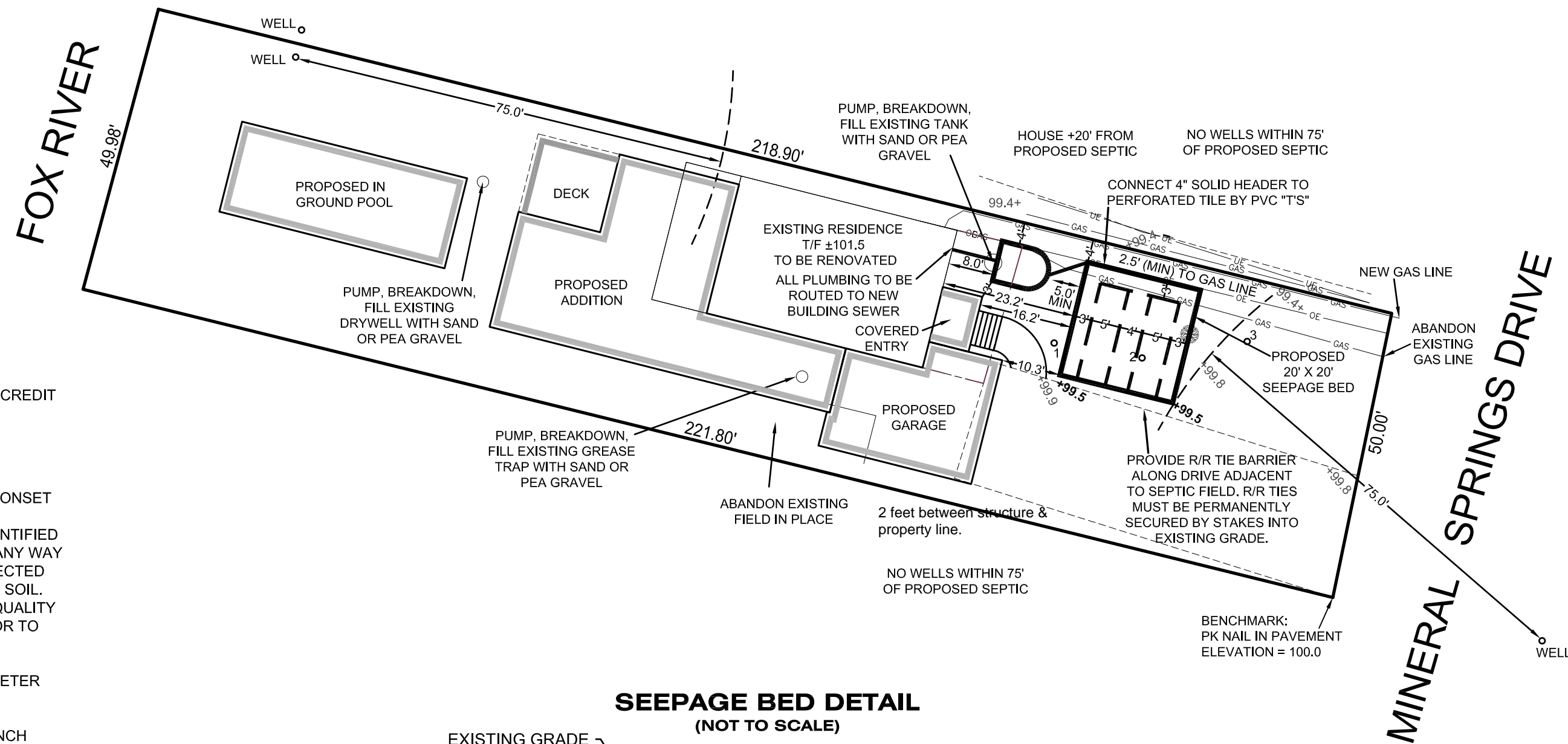

SEEPAGE BED DETAIL

(NOT TO SCALE)

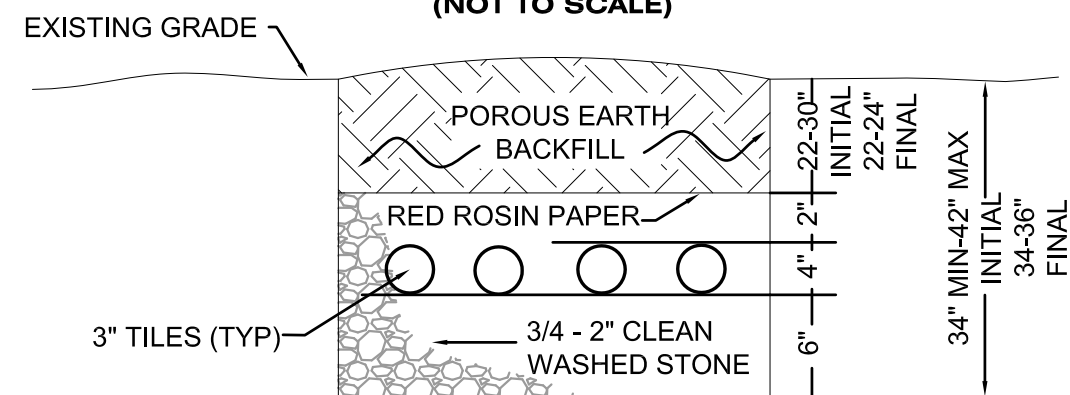

INSTALL BED 34-42" INTO EXISTING GRADE;
PROVIDE 0-6" CUT UPON BACKFILLING TO
MAINTAIN FINAL BED DEPTH OF 36" MAX.

SEPTIC SYSTEM DESIGN SIDE PROFILE (NOT TO SCALE)

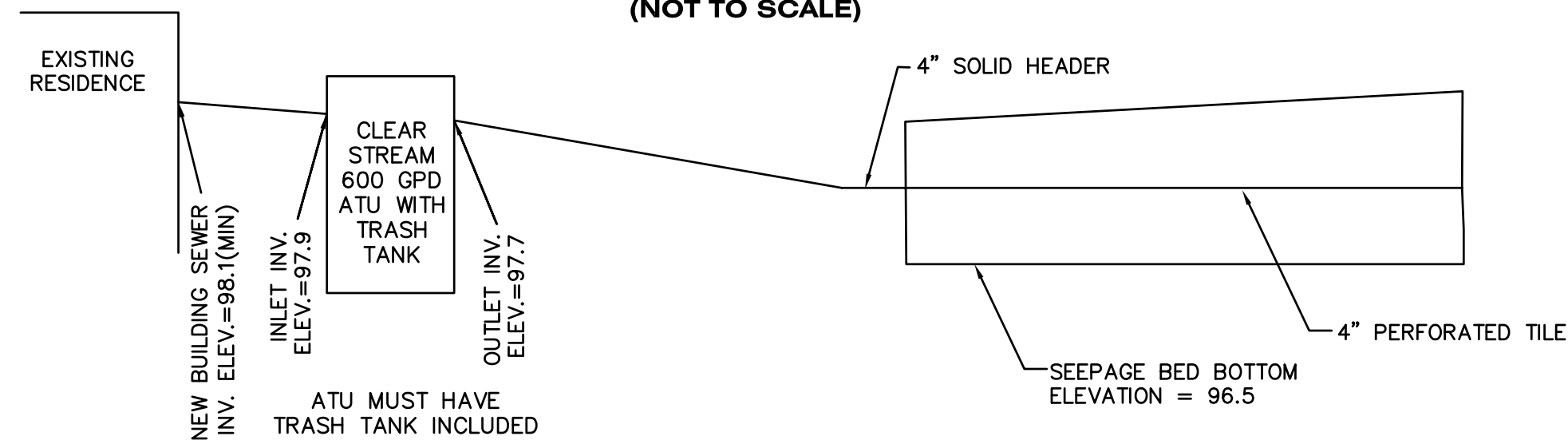
[illegible]

John M. Baber

John M. Raber L.E.H.P.
Lic.No. 0183-000258 Exp 4-30-26

SEPTIC SYSTEM DESIGN
505 MINERAL SPRINGS DRIVE
MCHENRY, ILLINOIS

CLIENT: PHIL DAVIS

LEGAL: LOT 16 BLOCK 1 MINERAL SPRINGS PARK

PIN: 09-36-329-008

Drawn By
JMR

Designed By
JMR

Date
1-23-25

Checked By
JMR

Job Number

24073