

Port of the Northwest Quarter of Section 23, Township 45 North, Range 6 East of the Third Principal Meridian, described as follows: Beginning at the Southeast corner of said Quarter Section and running thence North on the East line thereof for a distance of 905.51 feet to a point which is 1732.04 feet South on the Northeast corner thereof; thence North 66 degrees 44 minutes 09 seconds West, 420.65 feet; thence North 58 degrees 59 minutes 31 seconds West to a point on a line drawn from the Southeast corner and parallel to the East line of said Quarter Section, said point being 653.32 feet West of and parallel to the East line of said Quarter Section, said point being 1005.32 feet South of and parallel to the East line of said Quarter Section; thence South on the last mentioned parallel line to a point on the South line of said Quarter Section, thence East on the South line thereof for a distance of 330.00 feet to a point; thence North in a straight and direct line to the Place of Beginning, in McHenry County, Illinois.

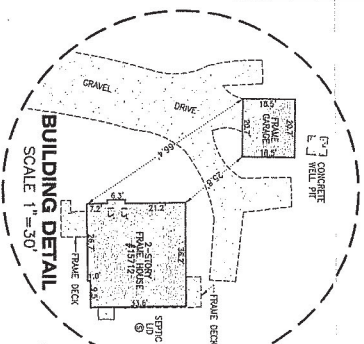

DRAWN BY: ST \_\_\_\_\_ CHECKED BY: WJV \_\_\_\_\_

NOTE: On those Building Use Restrictions or Easements on a Recorded Subdivision Plat are shown, unless the description ordered to be surveyed contains a proper description of the required building lines or easements, they should be surveyed by nothing. No underground improvements have been located unless shown and noted.

- \* No representation as to ownership, use, or possession should be shown implied.
- \* This Survey and Plat of Survey are not without original embossed or colored seal and signature affixed.

Complete your description and site markings with this plat and AT ONCE report any discrepancies which you may find.

In my professional opinion and based on my observations, I hereby certify that we have surveyed the premises shown on the attached plat and that the person is a true representation of the said survey. This professional service conforms to the current Illinois minimum standards for a boundary survey.

Dated at Woodstock, McHenry County, Illinois 4/28 A.D., 20 09.

Vanderslaapen Surveying & Engineering, Inc.  
Design Firm No. 184-002792

By: [Signature]  
Illinois Professional Land Surveyor No. 2709